

Model # BST-01

Instructions Sheet

BISTRO PICNIC TABLE

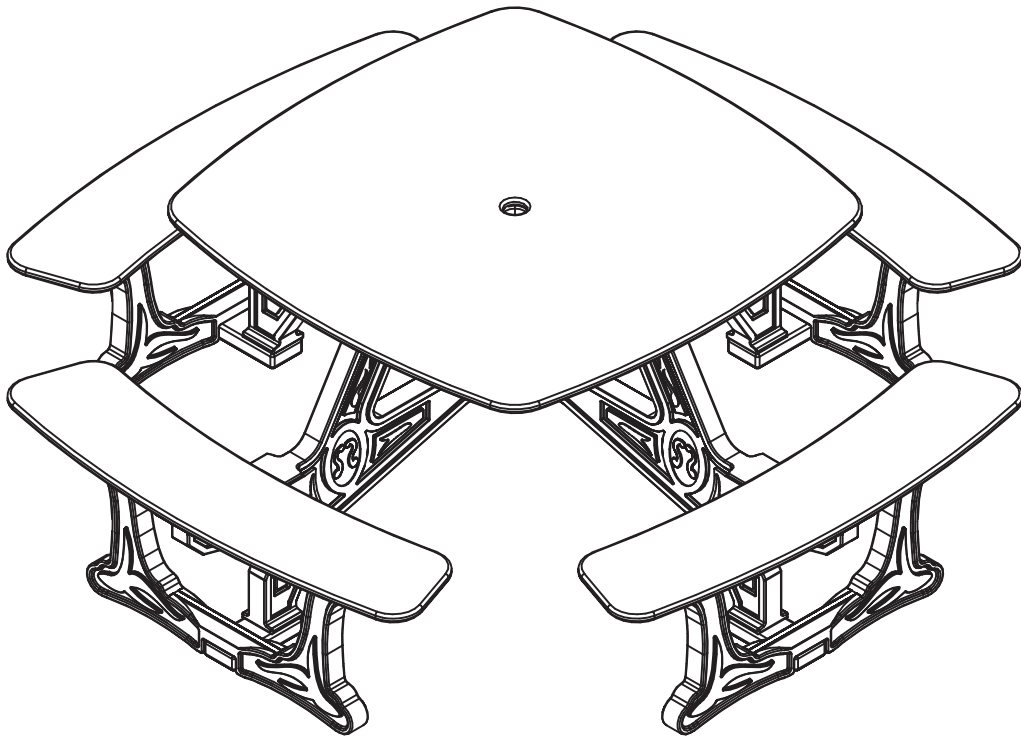

BEFORE ASSEMBLY, PLEASE MAKE SURE ALL COMPONENTS ARE INCLUDED.

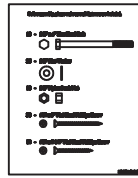

FP - FASTENER PACK
(1) - ONE FASTENER PACK

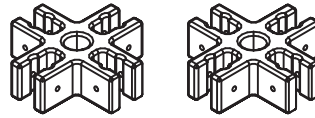

R - TABLE CENTER
(2) - TWO TABLE CENTERS

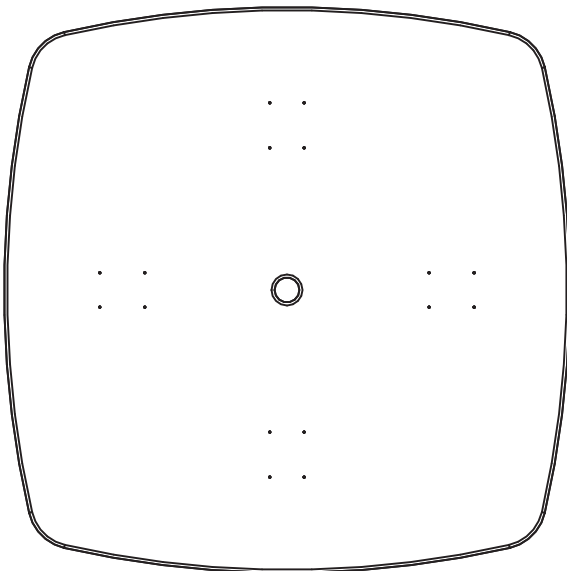

J - TABLE TOP
(1) - ONE TABLE TOP

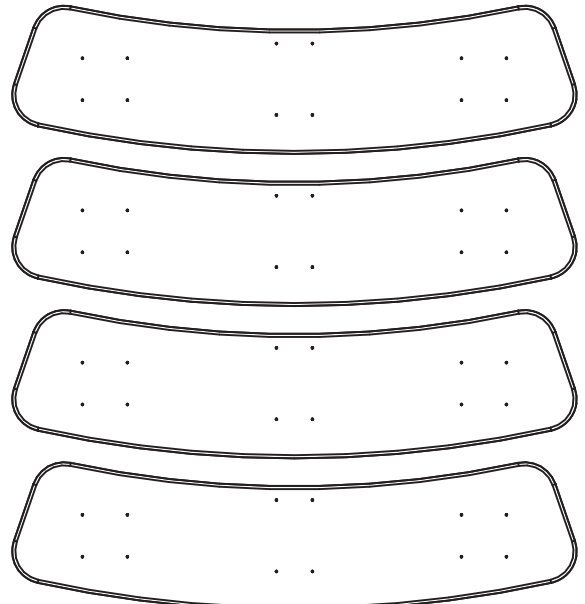

N - SEAT
(4) - FOUR SEATS

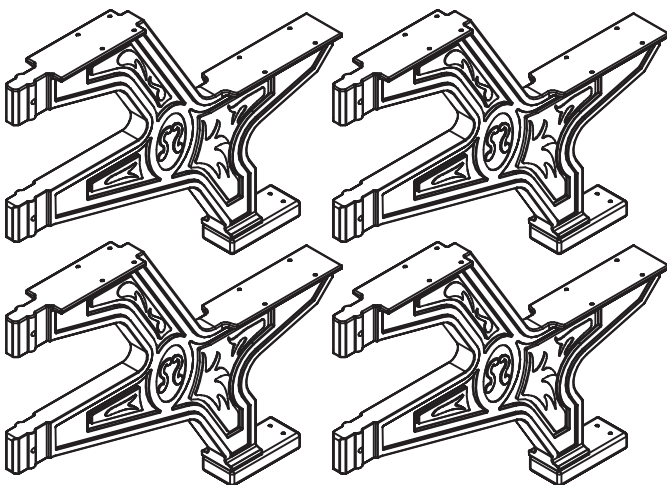

H - TABLE LEG
(4) - FOUR TABLE LEGS

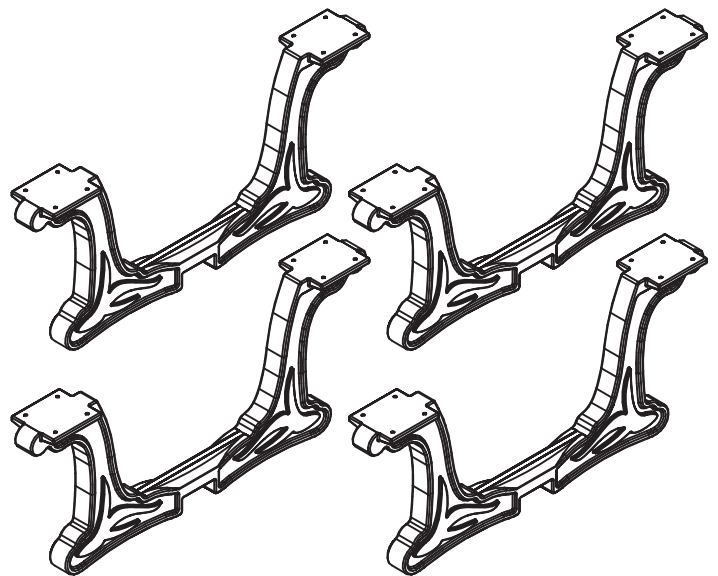

Q - SEAT SUPPORT
(4) - FOUR SEAT SUPPORTS

BEFORE ASSEMBLY, PLEASE MAKE SURE ALL FASTENERS ARE INCLUDED.

8 - 3/8" X 4-1/2" HEX HEAD BOLT

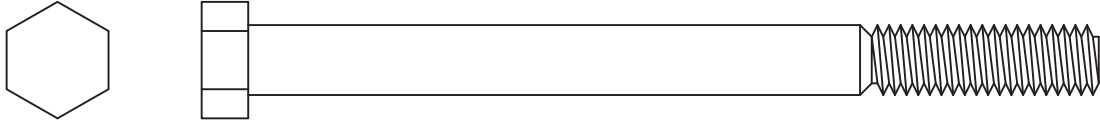

16 - 3/8" FLAT WASHER

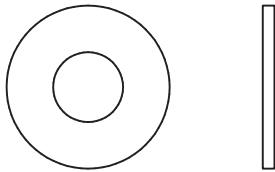

8 - 3/8" NYLON LOCK NUT

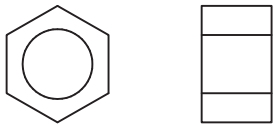

8 - #12 X 3" FLAT HEAD PHILLIPS SCREW



64 - #12 X 1" PAN HEAD PHILLIPS SCREW



ALSO NEEDED FOR THIS ASSEMBLY WILL BE THE FOLLOWING MATERIALS:

1 - 3" PHILLIPS DRIVE BIT

2 - 9/16" SOCKET WRENCH

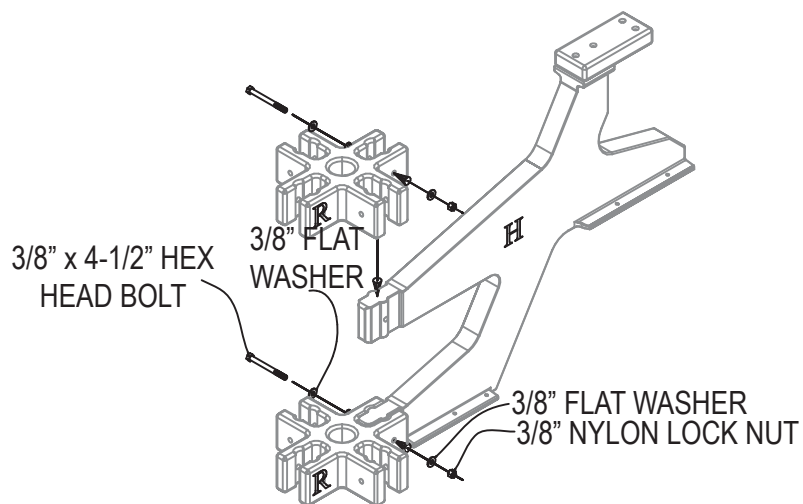

STEP #1:

SLIDE (1) ONE TABLE CENTER ONTO EACH END OF THE TABLE LEG AS SHOWN ABOVE. USE (1) ONE 3/8" X 4-1/2" HEX HEAD BOLT AND (1) ONE 3/8" FLAT WASHER ALONG WITH (1) ONE 3/8" FLAT WASHER AND (1) ONE 3/8" NYLON LOCK NUT PER HOLE TO SECURE. DO NOT TIGHTEN BOLTS COMPLETELY. THIS WILL BE DONE AT A LATER STEP.

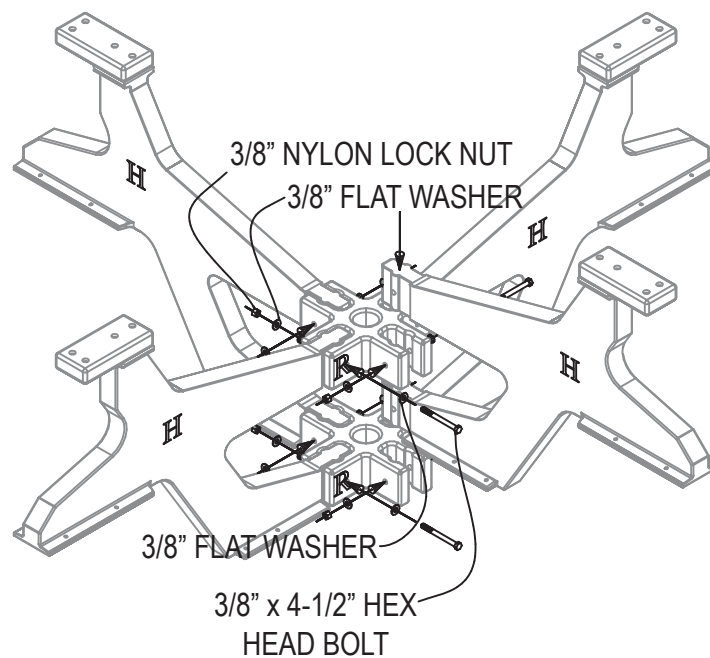

STEP #2:

SLIDE THE REMAINING (3) THREE TABL LEGS IN TO THE TABLE CENTERS. USE (1) ONE 3/8" X 4-1/2" HEX HEAD BOLT AND (1) ONE 3/8" FLAT WASHER, ALONG WITH (1) ONE 3/8" FLAT WASHER AND (1) ONE 3/8" NYLON LOCK NUT PER HOLE TO SECURE.

DO NOT TIGHTEN BOLTS COMPLETELY. THIS WILL BE DONE AT A LATER STEP.

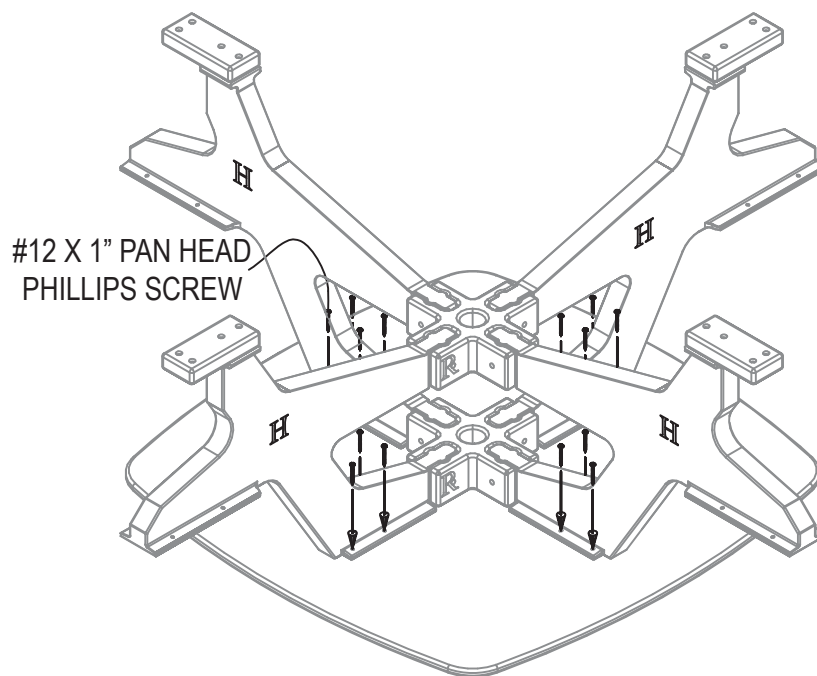

STEP #3: PLACE THE TABLE TOP UPSIDE DOWN ONTO A PIECE OF CARDBOARD OR ANOTHER SOFT SURFACE, TO PROTECT IT DURING INSTALLATION. PLACE THE LEG ASSEMBLY ONTO THE TABLE TOP AS SHOWN ABOVE. ALIGN THE PRE-DRILLED HOLES IN THE TABLE LEGS WITH THE PILOT HOLES IN THE TABLE TOP. USE (1) ONE #12 X 1" PAN HEAD SCREW PER HOLE TO SECURE.

BE SURE TO TIGHTEN ALL SCREWS AND BOLTS AFTER COMPLETING THIS STEP.

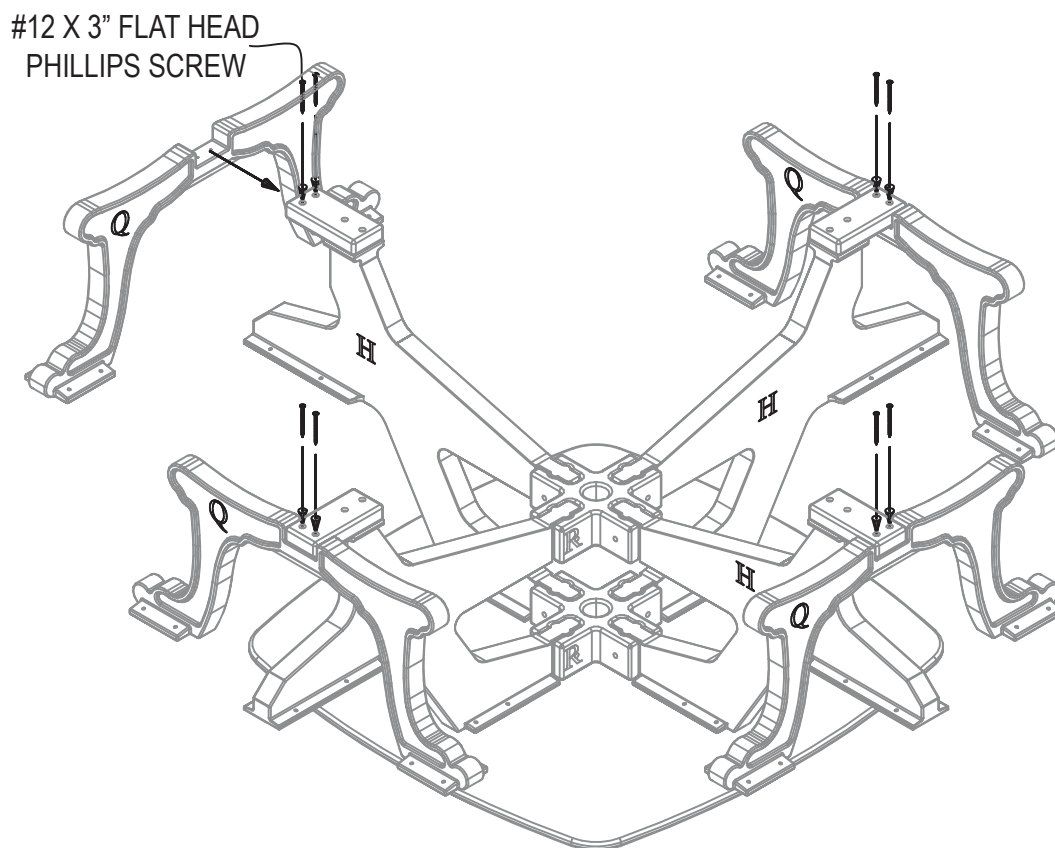

STEP #4:

WHILE THE TABLE IS UPSIDE DOWN, ALIGN THE PRE-DRILLED HOLES IN THE TABLE LEG TO THE PILOT HOLES IN THE SEAT SUPPORT, AS SHOWN ABOVE. USE (1) ONE #12 X 3" FLAT HEAD SCREW PER HOLE TO SECURE.

DO NOT TIGHTEN SCREWS COMPLETELY. THIS WILL BE DONE IN A LATER STEP.

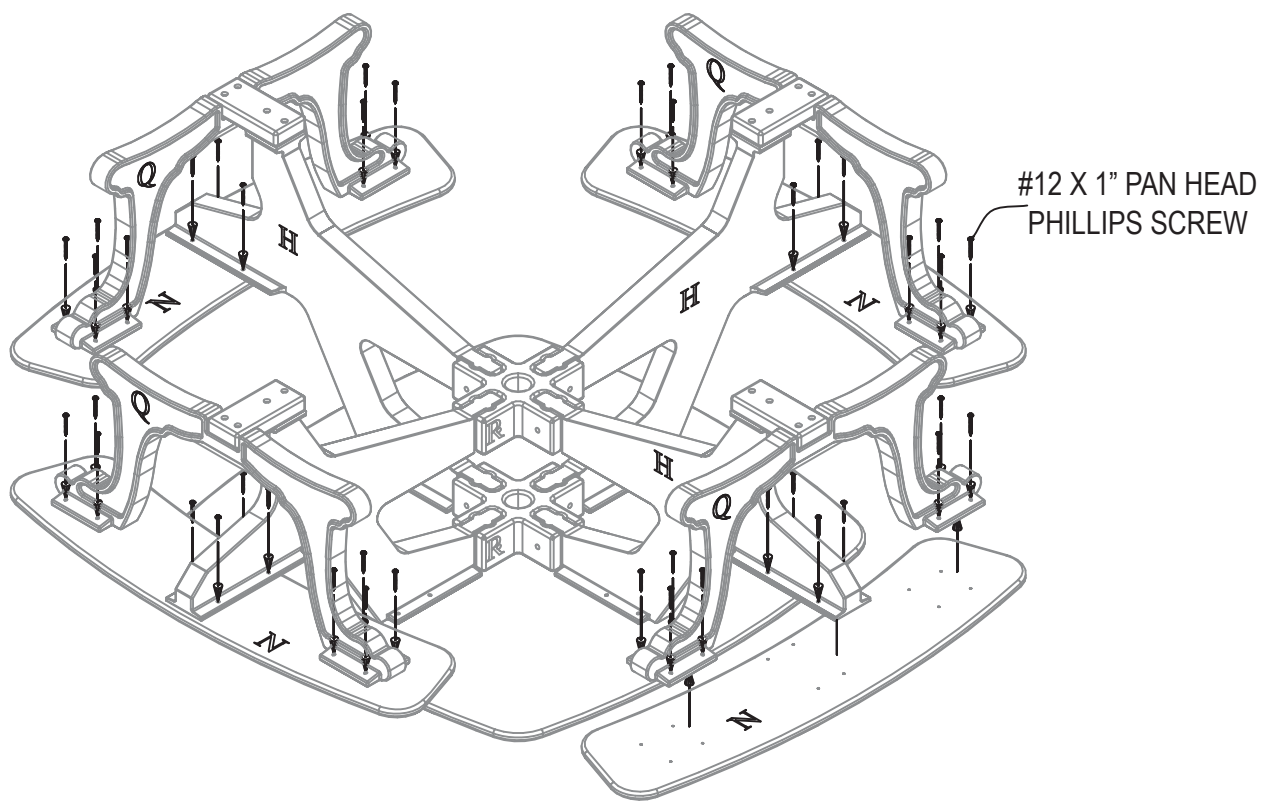

STEP #5:

WHILE THE TABLE IS UPSIDE DOWN, ALIGN THE PRE-DRILLED HOLES IN THE SEAT TO THE PILOT HOLES IN THE SEAT SUPPORT AND THE TABLE LEG AS SHOWN ABOVE. USE (1) ONE #12 X 1" PAN HEAD SCREW PER HOLE TO SECURE.

BE SURE TO TIGHTEN ALL LOOSE SCREWS AFTER COMPLETING THIS STEP.

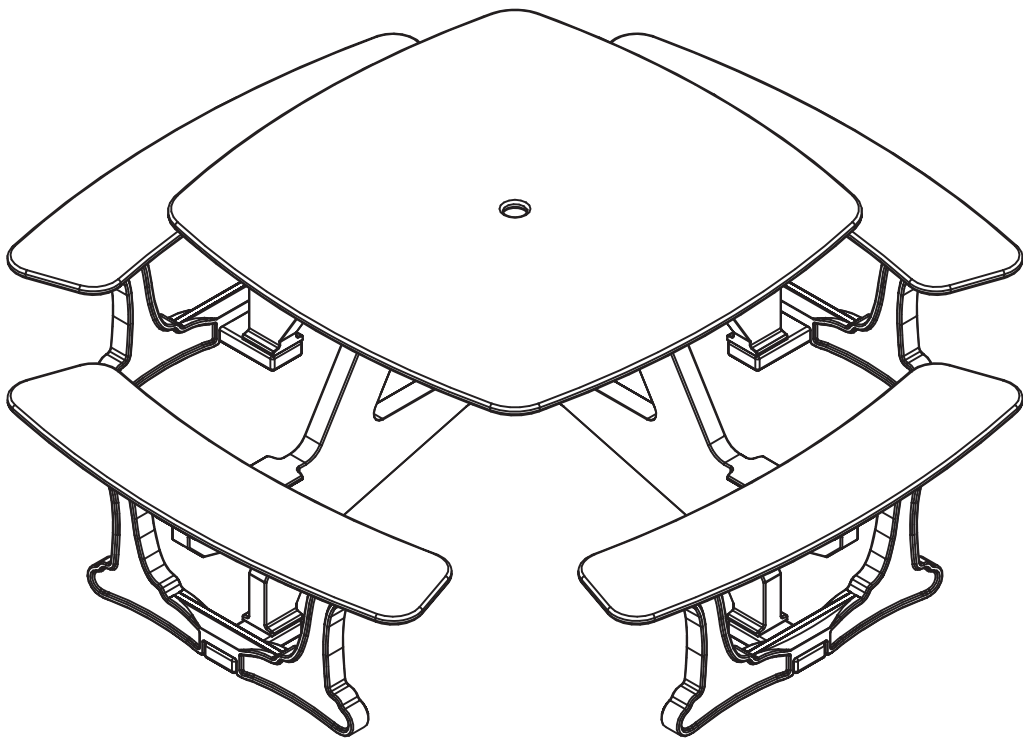

STEP #6:
TURN THE TABLE OVER ON TO ITS LEGS, PLEASE USE CAUTION FOR THE TABLE WEIGHS
APPROXIMATELY 200 POUNDS.